

REBEL TX-500
(Export modifications)
NOT FOR USE IN THE U.S.A.

HOW TO MAKE YOUR REBEL YELL!!!!

TUNE UP & POWER MODIFICATIONS

Stage 1

1. Adjust RV2 or cut D12 for maximum modulation.
2. Adjust L11-B and L7 for maximum power.

Stage 2

1. Change R97 from 10 ohm to 1 ohm
2. Change R130 from 100 ohm to 10 ohm

Stage 3

1. Change Q22 from 2SC2078 to 2SC1969
2. Replace R98 with a jumper

Swing Modification

1. Replace R95 with a (100 ohm to 220 ohm higher value = lower dead key).
2. Solder a 100 uf capacitor across R95 with + toward the front of radio.

Note: After completing Stage 1 any or all of these modifications can be done. Retune L11-B and L7 after modifications.

Rebel TX500

120 Channel Conversion (For export use only)

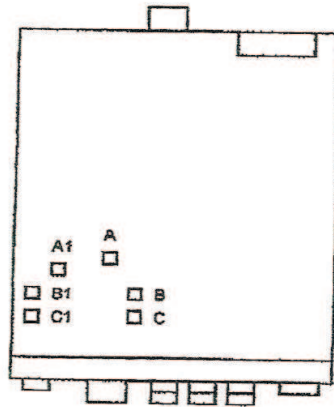

1. Move plug A to position A1
2. Move plug B to position B1
3. Move plug C to position C1

Note: The dimmer control now operates the bands.

Modulation: Adjust RV2 or cut D12

Power: Adjust L11-B & L7

Modification: Replace R97 to 1ohm and R130 to 10ohm

Rebel TX500

LT-2 Echo Board Installation

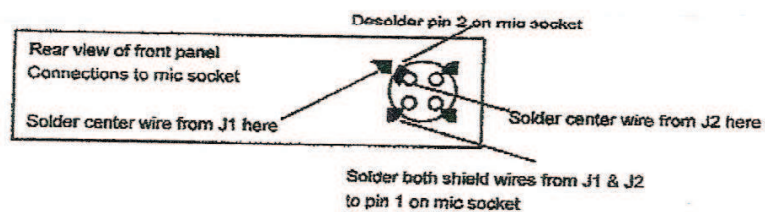
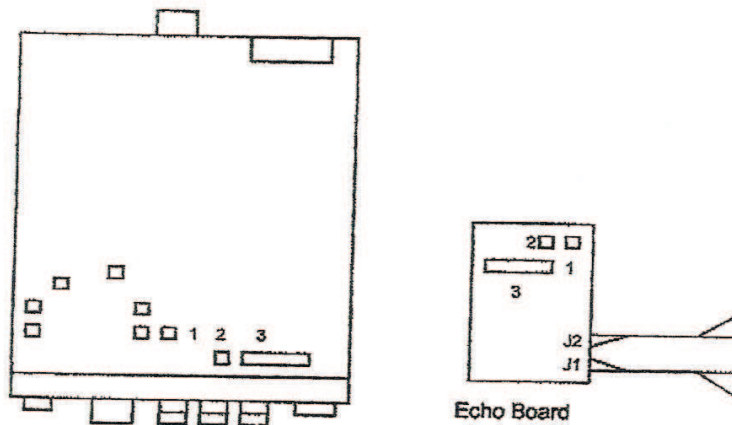

1. Unplug wiring from echo board, plugs 1, 2, & 3
2. Unplug wiring on radio, plugs 1, 2, & 3
3. Install wiring from radio to echo board, matching each number
4. Install cables J1 & J2 to mic socket (See diagram above)
5. Mount echo board to front right side tab on radio.

Note: Plug 1 on later models is loose in the radio and can be identified by the wire colors BROWN & GREY. The pink and black plug is for future use.